



UNLIMITED SNOW

For all imaginable **snow & ice** leisure experiences



Unlimited Snow
Nieuwe Gracht 11, 2011 NB Haarlem, Netherlands
+31 (0)20 4714640 / +31 (0)88 snowbiz
us@snow.biz
www.snow.biz
© UNLIMITED SNOW



Table of Contents

- Introduction.....3**

- Company Profile.....4**
 - Profile.....5
 - Team.....6
 - Projects.....7

- Service and Approach.....12**
 - Project Organization.....13
 - Process.....14

- Technology and Support.....18**
 - Sub-consultants.....19
 - Energy Strategy & Machine Room.....20
 - Snow-making.....21
 - Construction.....22
 - Envelope.....23
 - Attraction.....24
 - Operation.....25

About US

Unlimited Snow is a leisure development company specialized in Snow & Ice environments. It provides state of the art solutions for all conceivable snow & ice leisure concepts with its creations. It is known for its innovative and original concepts and reliable engineering. Its "snow-how" builds on the experience gained from many realized projects as well as continuous research and development. Services range from realization of turnkey projects to specialized advice and customized products. Close collaboration stimulates developers to employ their skills while strategic planning, concept development and project management ensure that all projects are kept on track. Even with the most daring assignments.

Unlimited Snow has proven to be a trustworthy partner for the development of snow and ice amusement parks. It's highly experienced team is capable of handling all design, technological and commercial aspects of projects to be conceived. The process remains under control from the first sketch till the start of a successful operation. And even beyond. US' expertise ensures that budgets are maintained and that the highest quality in terms of finish, environmental safety and final experience is achieved.

Our belief is that integration of the most innovative technology and high quality, durable realization are key to the creation of next generation snow and ice indoor amusement parks. With ultimately customized turnkey solutions, US realizes the most attractive, unique and profitable projects for any location or target group.

KEES ALBERS
CEO, Unlimited Snow



THE SNOW & ICE DEVELOPMENT COMPANY Company Profile



Company Profile

WHO WE ARE

Unlimited Snow (also referred to as US) was founded in 1995 under the guidance of Kees Albers, who already had an impressive career as a ski-instructor, freestyle ski competitor and coach at the Olympic Winter Games. In the early nineties, Kees and his predecessor enterprise were involved in the development and snow making of the first ever modern indoor snowdome. Later, Unlimited Snow became the first 'one stop shop' in providing virtually all imaginable services for permanent indoor snow & ice experiences, from concepts to turnkey development and additional entertainment.

Unlimited Snow takes care of every step towards completion of every turnkey project, and fulfils its customer's needs smoothly and reliably, sharing information and reporting all progress in a punctual manner. Handover and training is integrated as a "natural" process, tailored to the customer's vision and philosophy. Unlimited Snow takes pride in creating the most successful project for you location.

1. As a turnkey solution provider, Unlimited Snow provides the following service:

- Feasibility studies & Business plans
- Budget analysis
- Strategic & master planning
- Concept development & architectural and creative design
- Project consulting & project management
- Engineering & technical installations
- Fixed & mobile Snow making machines
- Fixed & mobile Ice making machines
- Ice rinks & Ice climbing
- Rides & attractions
- Specialist equipment & systems
- Theming & special effects
- Lighting systems
- Audio & Video systems
- Prefab & Instant structures
- Operational support & management
- Operations
- Merchandising & promotion
- Additional leisure facilities & franchise
- The Experience Ticket online reservation and visual queuing system
- Tape My Day® camera system

2. As a partner of your business:

Unlimited Snow fosters strategic relationships by investing in a variety of projects in ice & snow domes, rides & attractions, technology and research & development. Proven expertise in strategic planning and experience design helps US' partners craft, execute and expand their vision and stems from a core belief in helping passionate people to achieve their goals.

3. Franchises:

Unlimited Snow's core focus is developing original, fully immersive snow & ice entertainment experiences that are scalable, repeatable and catered to regional markets anywhere in the world. Unlimited Snow is open to collaboration with other enterprises in long-term franchises, bringing indoor snow and ice experience to a new level of commercial branding and merchandizing. These franchises include exciting and immersive experiences that are modular, scalable, and feasible.



US Project Team



Kees Albers

CEO

- Creative mind
- Founder Unlimited Snow
- Research and development
- Strategic planning & financials
- Years of experience 40+



Bert Cornelisse

PROJECT DIRECTOR

- Project & production management
- Master planning
- Creative direction
- Years of experience 40+



Alex Lokhorst

OPERATIONS DIRECTOR

- Operations management
- Hospitality
- Concept development
- Years of experience 20+



Dennis Dijkman

TECHNICAL MANAGER

- Facility management
- Snow and ice development
- International ski instructor
- Years of experience 20+



Moes el Madhoun

PROJECT MANAGER

- Project management
- Budget control / calculations
- Quality control
- Years of Experience 20+



Irma Munneke

PROJECT ARCHITECT

- Architectural design
- Technical design
- Project management
- Years of experience 20+



Annelies van Berckel

ARCHITECTURAL DESIGNER

- Creative development
- Design development
- Production design
- Years of experience 20+



Jorrit Scharloo

ARCHITECTURAL ENGINEER

- Mechanical design & engineering
- Documentation & production
- Design development
- Years of experience: 10+



Ka Fung Chan

ARCHITECTURAL DESIGNER

- Creative development
- Production design
- Scenic design
- Years of experience 10+



Alvina Shuo Li

ARCHITECT

- Architectural design
- Interior design
- International collaboration
- Years of experience 5+



Ridley Ding

ARCHITECTURAL ENGINEER

- Design development
- Technical design
- International collaboration
- Years of experience 5+



Jeffrey Steenberg

GRAPHIC DESIGNER

- Environmental graphic design
- Creative nomenclature
- Art direction
- Years of experience: 5+

Project Overview

Over the decades, Unlimited Snow has executed design and construction as general contractor for several indoor snow & ice facilities, as well as snow productions for many events worldwide. The budget managed in each project has varied from a few thousand euros to 200 million. Projects at different continents have enabled Unlimited Snow to be the most experienced partner in international collaborations, which has generated a lot of trust, goodwill and support all around the world.

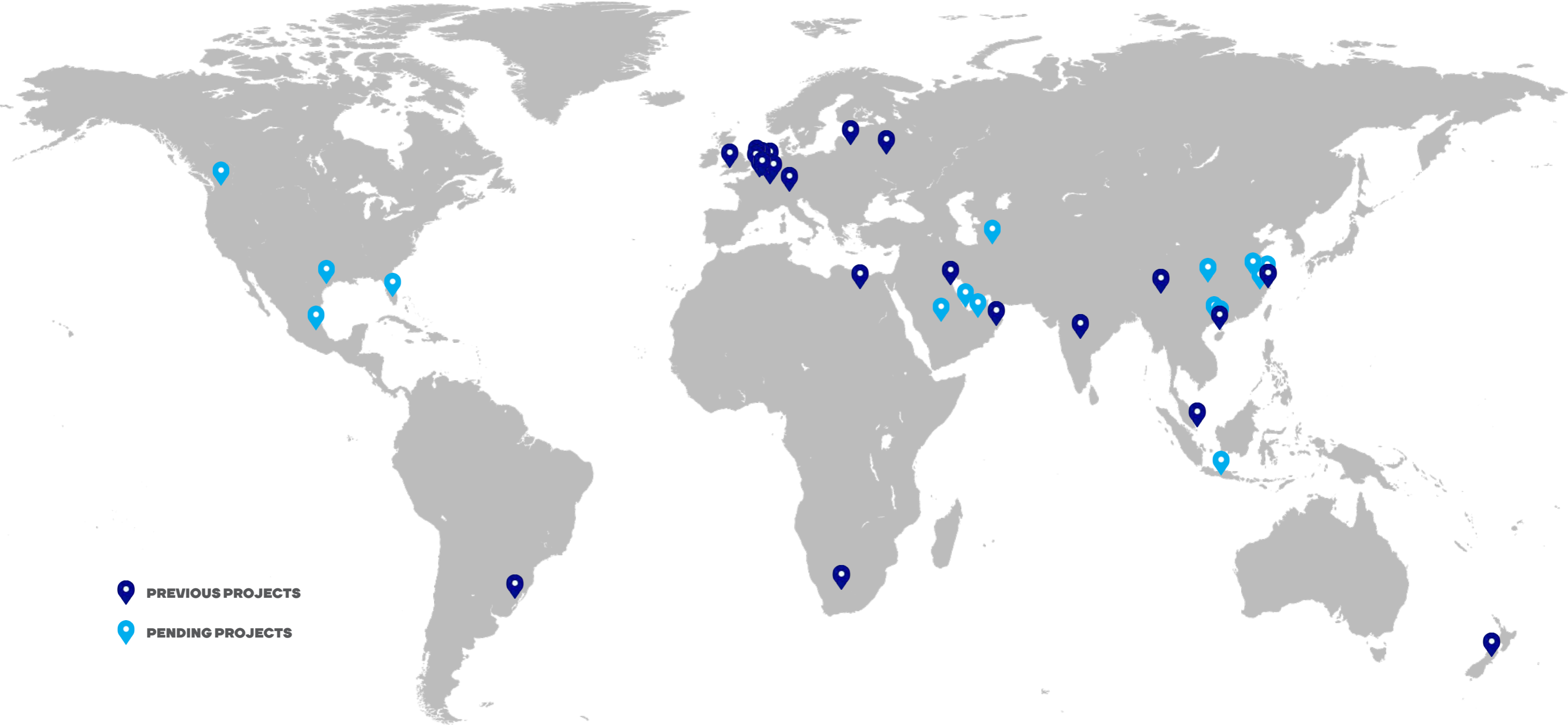

Track Record

SNOW MAKING EQUIPMENT

Shaab Park, Kuwait

mobile snow making machine

Empa and avalanche institute Zurich, Switzerland

snow making installation

Snow City, Jurong, Singapore

polar snow making installation

International Antarctic Centre, Christchurch, New Zealand

polar snow making installation

Event company, South Africa

mobile snow making machine

Ocean Park, Hong Kong, China

snow making installation

SNOW MAKING

SkiDôme, Rucphen, Netherlands

snow making, sponsoring, ski instruction-coordination

Snow World, Zoetermeer, Netherlands

snow making, equipment supply, sponsoring, ski school management, marketing management

Montana Snow Center, Westerhoven, Netherlands

cryogenic snow making installation

Snow Village, Biddinghuizen, Netherlands

polar snow making installation, equipment supply

Snow Fun Park, Wittenburg, Germany

polar snow making half pipe

Winter Efteling, Waalwijk, Netherlands

snow theming winter opening attraction park

CONCEPT DESIGN

Ski Park, Guangzhou, China

concept design

Arctic World, Almere, Netherlands

concept design

Ski Park, Wuxi, China

concept design, schematic & detailed design

Grand Alps Snow Dome, Irving, Texas, USA

concept design

Silver Dome - Dune Park, Viavari, Letvia

concept design

Snow Mountain, Houston, Texas, USA

masterplan

Snow & Ice amusement park, Wuhan, China

concept design and consultancy

Kernwasser Wunderland, Kalkar, Germany

concept design

Mall of Arabia, Cairo, Egypt

concept design

Snow Dome Thialf, Heerenveen, Netherlands

concept design and consultancy

Snow Dome, Chengdu, China

masterplan

Winterland, Shanghai, China

masterplan, concept design, general calculations, ongoing

CONSULTANCY

Snow dome, Kuwait

consultancy

Freestyle ski park, Moscow, Russia

consultancy

Xscape, Milton Keynes, United Kingdom

business plan study

Ski Dome, Cardiff, United Kingdom

consultancy

Snow World, Hyderabad, India

consultancy, layouts and design

Snowland, Mexico City, Mexico

consultancy

Ski Dubai, Dubai, UAE

Snow maintenance and consultancy

Snowbase, Terneuzen, Netherlands

snow and technical management and consultancy

Ski Egypt, Cairo, Egypt

snow and technical management and consultancy

Snowland, Gramado, Brazil

consultancy

TURNKEY PROJECT

Snow Village, Jeddah, Mall of Arabia, Saudi Arabia

Snow Park, Muscat, Palm Mall, Oman



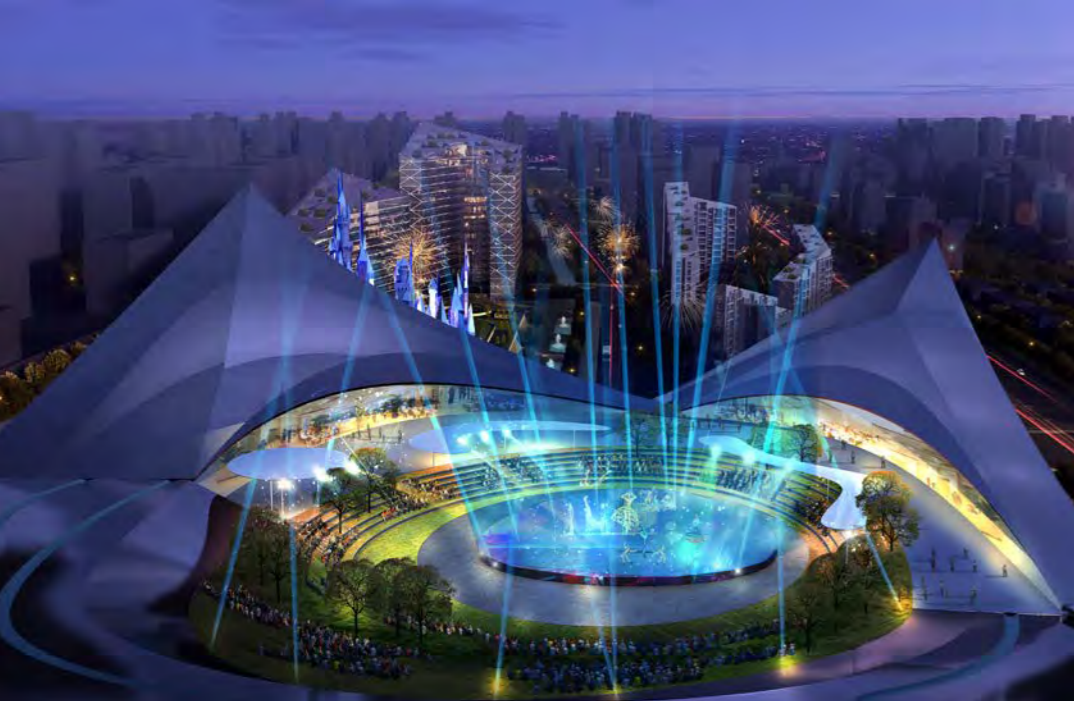

WINTERLAND | SHANGHAI, CHINA

Client: KOP Properties

Finished stages:

- Feasibility studies & Business plans
- Budget analysis
- Strategic & master planning
- Concept development & architectural and creative design
- Project consulting & project management
(Other stages are in progress)

Planned opening time: 2020

Description:

Winterland Shanghai will be located in Lingang City, with a site area of approximately 107,000 square metres. Located close to the site of the Shanghai Haichang Polar Ocean Park and just within minutes from the Shanghai Disney Resort, Winterland Shanghai will boast a gross floor area of approximately 213,000 sqm, providing residents and visitors

with year-round access to the largest indoor Olympic-grade winter sports facility, winter sport competitions, ice sculpture shows, exciting retail, and food and beverage establishments. The development will also feature a ski-in ski-out resort, an indoor waterpark, an outdoor waterpark, an ice hotel and several theatres showcasing a wide variety of theatrical shows, concerts and multi-dimensional cinematic displays.

Description:

The Snow Park represents a world first new generation real snow & ice amusement park. Visitors are "beamed" into an Alpine winter landscape with realistic mountain sceneries, Alpine chalet facades, snowy rockwork, F&B terraces with themed furniture, huts, trees, snowfall and sound & light effects. Mall visitors can already get a taste of the excitement from behind the mall windows, providing them a view at the Snow Park.

The warm zone includes the reception, rental area, the dressing rooms and the merchandising shop as well as a separate Ice Bar and Alpine café. The cold zone is divided over 2 levels and comprises numerous snow & ice fun rides and attractions for the whole family to enjoy.

Client: Al Jarwani Group

Scope:

- Feasibility study
- Consultancy
- Project management
- Master planning
- Schematic & concept design
- Design development
- Tender documents
- Technical design
- Specialist equipment & systems
- Theming & special effects
- Lighting systems
- Audio Visual systems
- Content production
- Construction, production and fabrication
- Installations attraction
- Testing & programming
- Pre opening & training
- Operational support & management
- Operations
- Merchandising & promotion
- Character design
- Merchandising design
- Engineering
- Attractions
- 50% joint adventure and franchise
- Machine room (HVAC/snow-ice equipment)
- The Experience Ticket online reservation and visual queuing system
- Tape My Day® camera system

Planned opening time: 2018

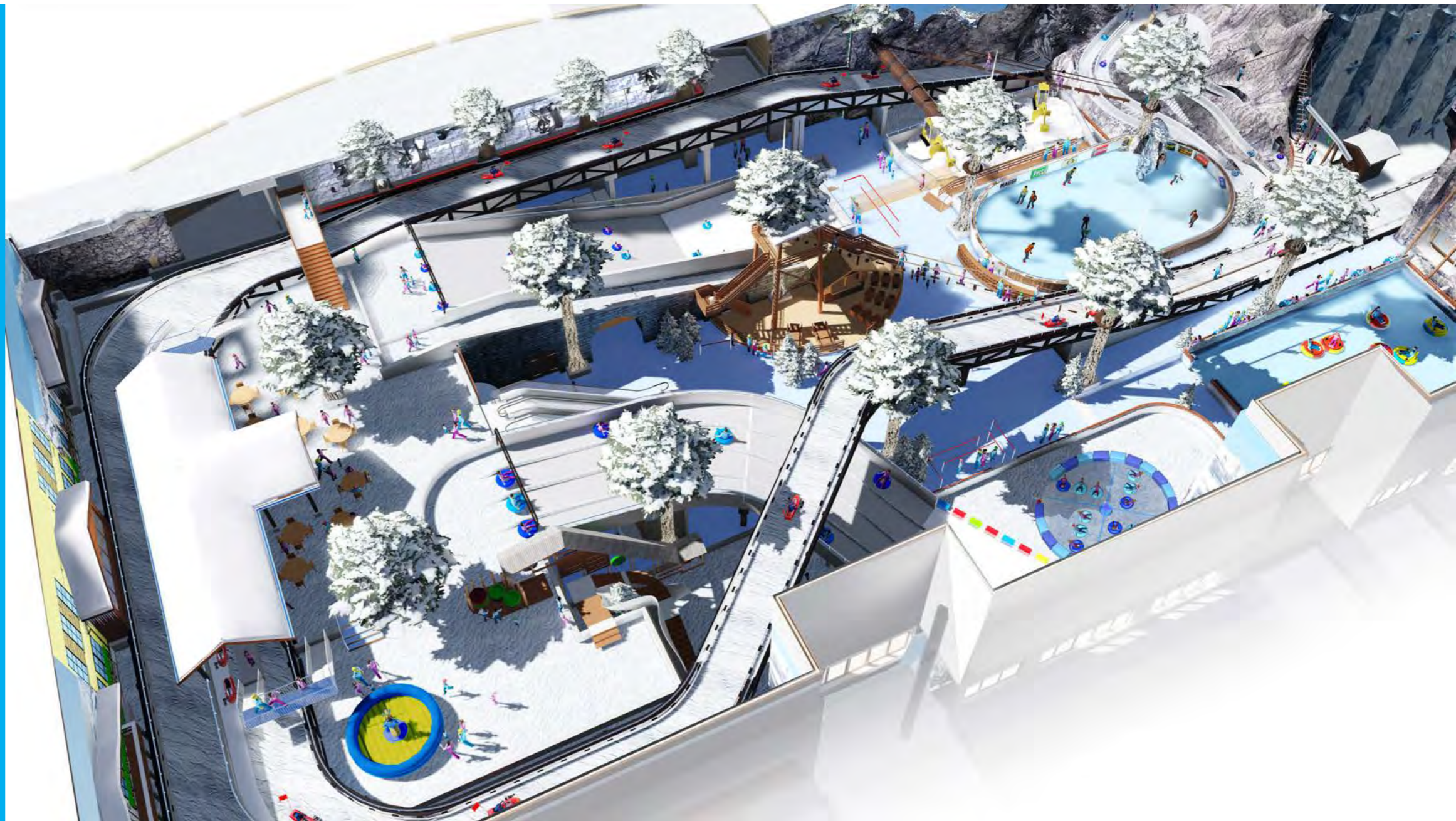

SNOW VILLAGE ARABIAN CENTRES, RIYADH



Description:

A new Snow Village to be built for Saudi Arabia, as part of a new mall development in Riyadh. The Snow Village aims for a new generation of winter themed indoor real snow and ice amusement parks. Covering approximately 5,000 square metres. There will be 15 snow and ice fun rides and attractions for children and families, which has an indoor temperature above zero to allow free snow play.

The visitors will be virtually brought into a fantastic Alpine and snowy mountain landscape with huts, trees, snowfall, sound and light effects as well as Polar bear animatronics. Rides and attractions include an explorer snow circuit with snowmobiles, a snow carousel, bumper cars and alpine curling on ice, an ice-carving igloo, etc.

Client: Arabian Centres

Scope:

- Feasibility study
- Consultancy
- Master planning
- Schematic & concept design
- Design development
- Technical design
- Construction, production and fabrication
- Character design
- Merchandising design
- Engineering
- Theming
- Attractions
- Machine room
- Project management

YOUR PARTNER TO SUCCESS FROM A WHOLE NEW PERSPECTIVE

Service and Approach



Project Organization

Unlimited Snow's core team will work in collaboration with the customer to lead a design process that works within the budget and timeline. We will rely heavily on the customer's feedback and factor in the time needed for this in our design process. Key members of the customer's team will be involved in the development process by means of conference call updates, design & budget meetings and milestone reviews. Unlimited Snow has established a reputation by working under extreme conditions and tight schedules, and collaborating with external consultants to drive the production forward, respecting its deadlines.

All four departments and sub-consultants are accredited feasibility companies, operations management firms and/or fabrication/specialty shops. In order to ensure that Unlimited Snow's vision is met, its project team is based on the specific skill sets unique to the needs of creating immersive snow & ice environments. The Unlimited Snow Project Team comprises seasoned storytellers and audio & film producers. Unlimited Snow Project team staff will continue to oversee the project, and will always take part in creative development, production management and strategic planning for the duration of each design phase.



The Process

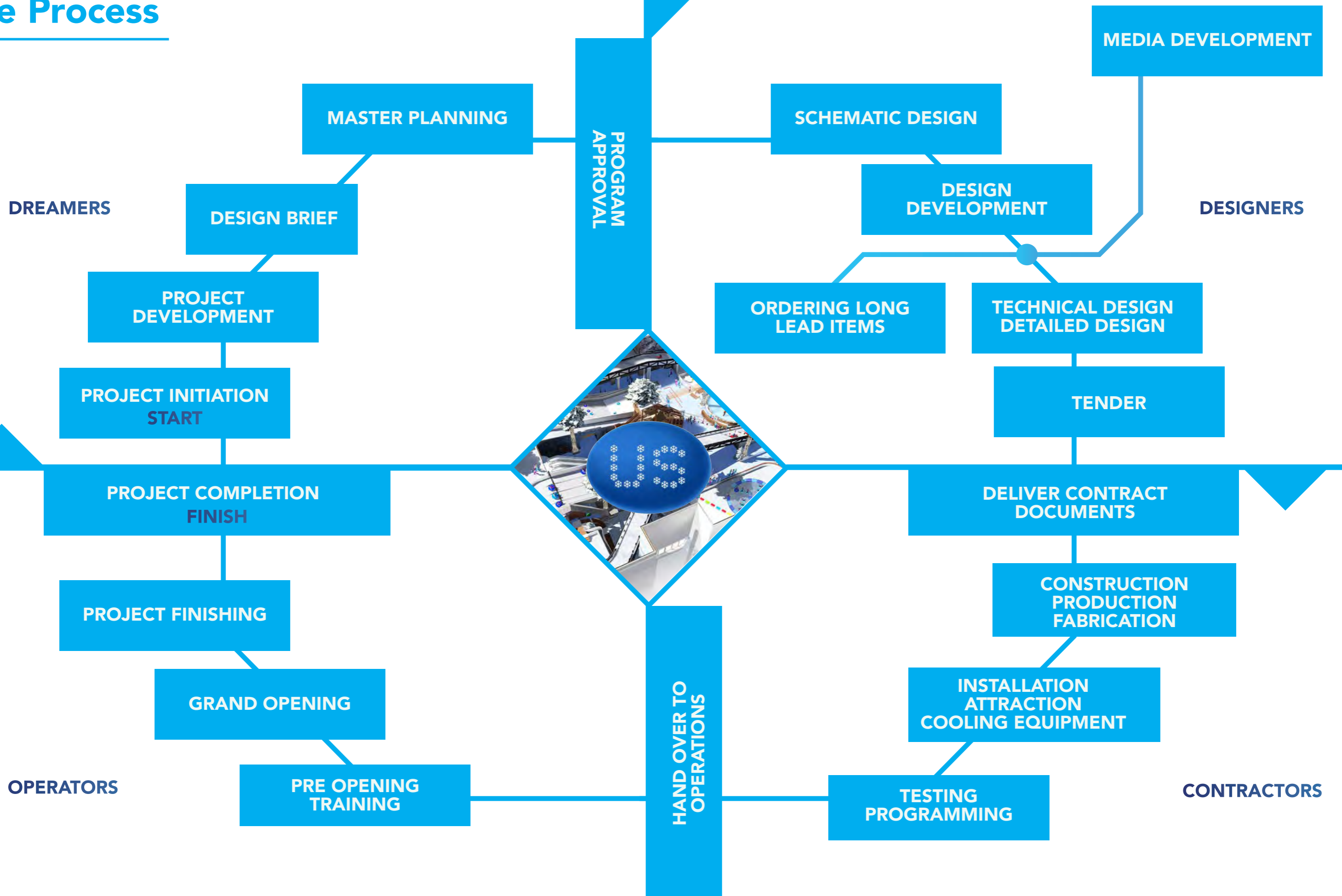



A Creative Process

Unlimited Snow is experienced in creating all snow & ice related entertainment facilities, being the expert in the market to bring natural snow & ice experience into a well-planned indoor space. Starting from feasibility studies and provisional masterplans in the initial stage to the final result, US' collaborative creative minds continue to look for the best solutions possible to realize the clients' dream. In this creative process, 3D representations and other forms of design documents are used to inspire other parties invited in the process. US' architects, theme designers, engineers and sub-consultants work together in different stages to make the most creative design possible, while at the same time tackle possible problems even before they rise.

The Process - From Idea to Reality

PRE-FEASIBILITY, MASTER PLANNING & CONCEPT DESIGN & DEVELOPMENT

The primary goal of phase one is to develop the overall concept and to start envisioning the experience for each of the attractions. A written narrative is created outlining the experience from entry to exit. A master plan is developed to organize the program while artwork is created to help the customer and the team envision the look and feel of the project. In order to already assess progress in later construction, it is critical that a pre-feasibility study is performed and a facility impact report generated.

FEASIBILITY & BUSINESS PLAN

During the second phase a detailed feasibility study and a concept business plan will be delivered. Unlimited Snow tends to work with preferred and respected consultants for feasibility studies and business plans, so that the customer gains deeper insight into the revenues, budget plans, market analysis, financial projections and the consequences of program mix configurations evolving from the Concept Design Phase that have been designed to meet the target numbers.

SCHEMATIC DESIGN

During the Schematic Design, the big ideas generated during the previous phase are translated into preliminary drawings showing sizing and general specifications, which can be shared with architects, engineers and other vendors. Essential infrastructural requirements such as power and water are provisionally defined. A much more detailed development package will be provided in the next phase of work. The above documents are compiled within a "Schematic Show Package" and an "Architectural Design Package" consisting of facility layout plans for attractions, initial technical show systems designs (lighting, audio, control, etc.), elevations/drawings for all themed facades, etc. The mix of story-driven environments, themed facades and off-the-shelf attractions must be integrated into the facility. It is during this phase that a Facility Design Architect will join the team to ensure a smooth integration.

DESIGN DEVELOPMENT, TENDER DOCUMENTS & TENDER APPRAISAL

During Design Development, the Schematic Show Package, Tender documents & Tender Appraisal from the previous phase is drilled down to add and specify further details. Unlimited Snow develops the design packages for attractions by working with the architect's records, while the facilities are developed. Included in the design package is intent for graphics and signage, media pre-production treatment and scaled drawings & descriptions of all project elements to help communicate the design intent with manufacturers and specialty vendors.



The Process - From Idea to Reality

CONSTRUCTION, PRODUCTION & FABRICATION

While the facilities are being constructed, the attractions and exhibit pieces begin fabrication. During the Production and Fabrication Phase, the media (both video and audio) are developed while the environment, attractions and theming are manufactured. Unlimited Snow works with composers and media producers, to create the specialty media (if needed) for the project and will provide oversight of the build of the attractions, scenery, theming, props, and effects. Partial pre-testing will be performed at all individually functional elements.

INSTALLATION & PROGRAMMING

The project comes together during the Installation and Programming Phase. Unlimited Snow manages the installations of all elements such as: the ice & snow installations, attractions, theming, scenery, props and effects and leads the programming of lights, audio and video elements. Comprehensive tests are being performed on all parts of the system, preferably in their coherence and under low temperatures and realistic humidity. For a Snow Theme Park, it will be essential to allow enough time for the temperature to drop to the target temperature, especially when differential temperatures (inside versus outside) are significant.

TRAINING/HANDOVER/OPENING

Unlimited Snow strongly believes in a thorough training of and handover to the operational staff. A proper handover is key to the success and longevity of the project and its specialized hardware. Unlimited Snow will work directly with the customers' staff to help train them in the proper way to operate and maintain all components of the system in a safe and efficient way. Hands-on training in the most realistic manner also provides input for the formal handover, that will be officially scheduled before the opening and transfer of all property (following the corresponding articles in the contract).

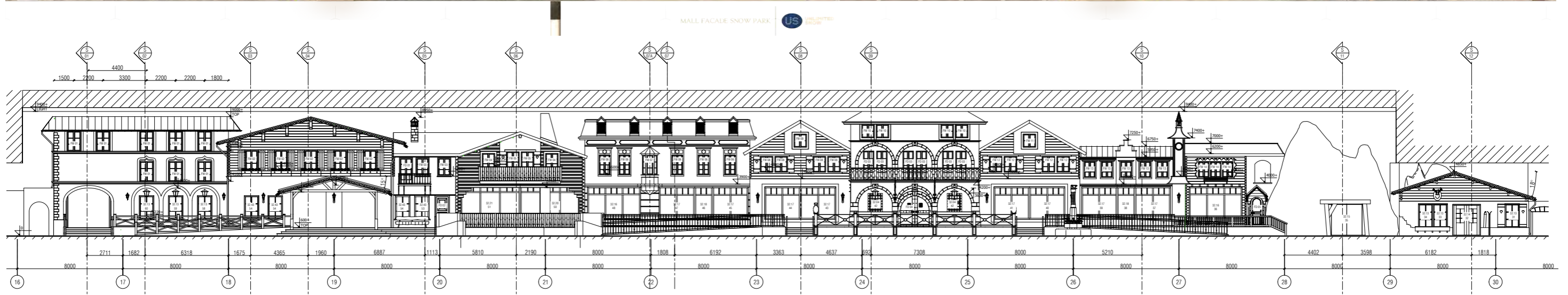

ESSENCE FOR QUALITY PROJECTS

Technology and Support

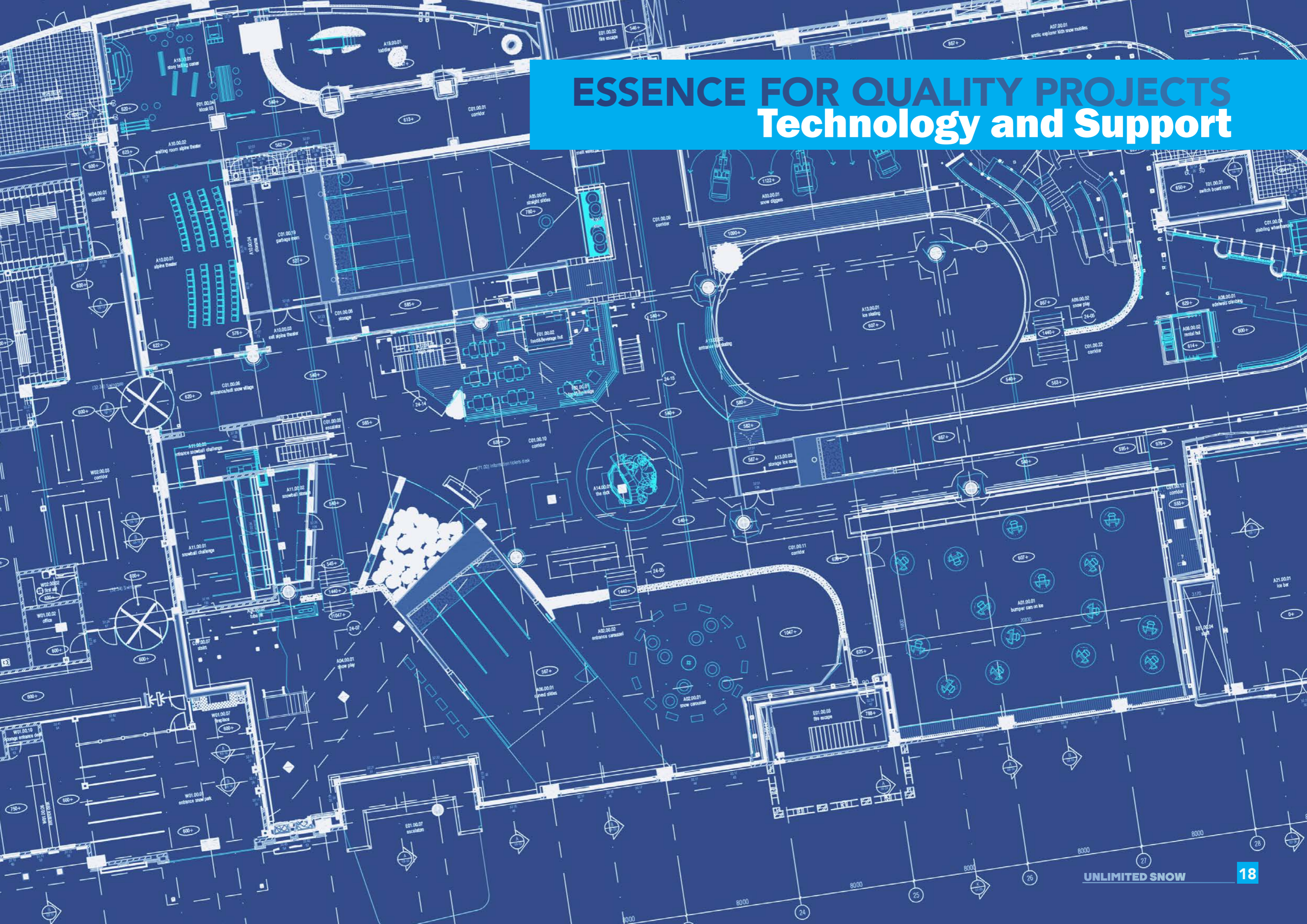

Sub-consultants

Snow and ice indoor theme parks are complex projects that require close integration of architects, construction engineers, MEP specialists, theme & media designers, and a whole range of contractors and other professionals. Unlimited snow is the most experienced as well as efficient party to take lead in such projects as a turnkey solution provider. As part of its overall design and development process, Unlimited Snow anticipates working with and managing the following sub-consultants.



ARUP



GIEBROS

Giebros Technics Projects B.V. situated in the Netherlands, operates all over Europe and outside Europe, has specific knowledge and a considerable experience in relation to design, engineer, assemble, produce, install and maintain mechanical installations in all types of facilities. Giebros Technics realized over 400 "Prefab Machine Room Installations" in snow and ice facilities, water parks, etc.

ARUP

Worldwide, Arup is one of the most well-known and authoritative engineering firms, with 70 years of experience. Having hundreds of engineers based in Amsterdam, they take care of interdisciplinary projects in aspects including structural engineering, building physics and construction. Their services are delivered locally through 34 offices on all continents, including 9 offices in Greater China. Unlimited Snow has been collaborating with Arup in several successful projects, bringing technical innovation to a new level.

WT PARTNERSHIP

WT Partnership is an award winning international practice of property, project and cost management consultants in building construction, infrastructure and management of facilities. WT Partnership provide consultancy services on a wide range of commissions for public and private sector clients worldwide, drawing on the resources of over 1,250 staff operating from offices throughout the United Kingdom, Europe, South East Asia, Central America, Australia and the Pacific.

Energy Strategy & Machine Room

- ENERGY SAVING
- COST REDUCTION
- DURABILITY

Snow and ice projects such as ice rinks, leisure ice, snow domes, snow play and additional mixed use facilities are quite complex and require very specific technical installations.

For significant energy savings or for reducing the use of energy from the grid to an absolute minimum Giebros Technics facilitates a full integration of all components of the installation leading to a minimum energy consumption under operational circumstances. Apart from limiting operational costs it is also of environmental importance to achieve a considerable reduction of CO2 emissions. In case this is commercially viable energy power plants are applied with the presently most efficient and state of the art combination of heat and power (HCP) and solar energy in an energetic, ecological as well as financial sense.

Because of its specific know how and applied superior materials making the machine room installations last for at least 20 years, Giebros Technics has built an outstanding reputation among its sports and leisure projects clients during the past 30 years. A total of 472 projects have so far been realised in the Netherlands and abroad.



Psychrometric Chart

Location: SHANGHAI, CHN
Frequency: 1st January to 31st December
Weekday Times: 00:00-24:00 Hrs
Weekday Times: 00:00-24:00 Hrs
Barometric Pressure 101.36kPa
© Weather Tool

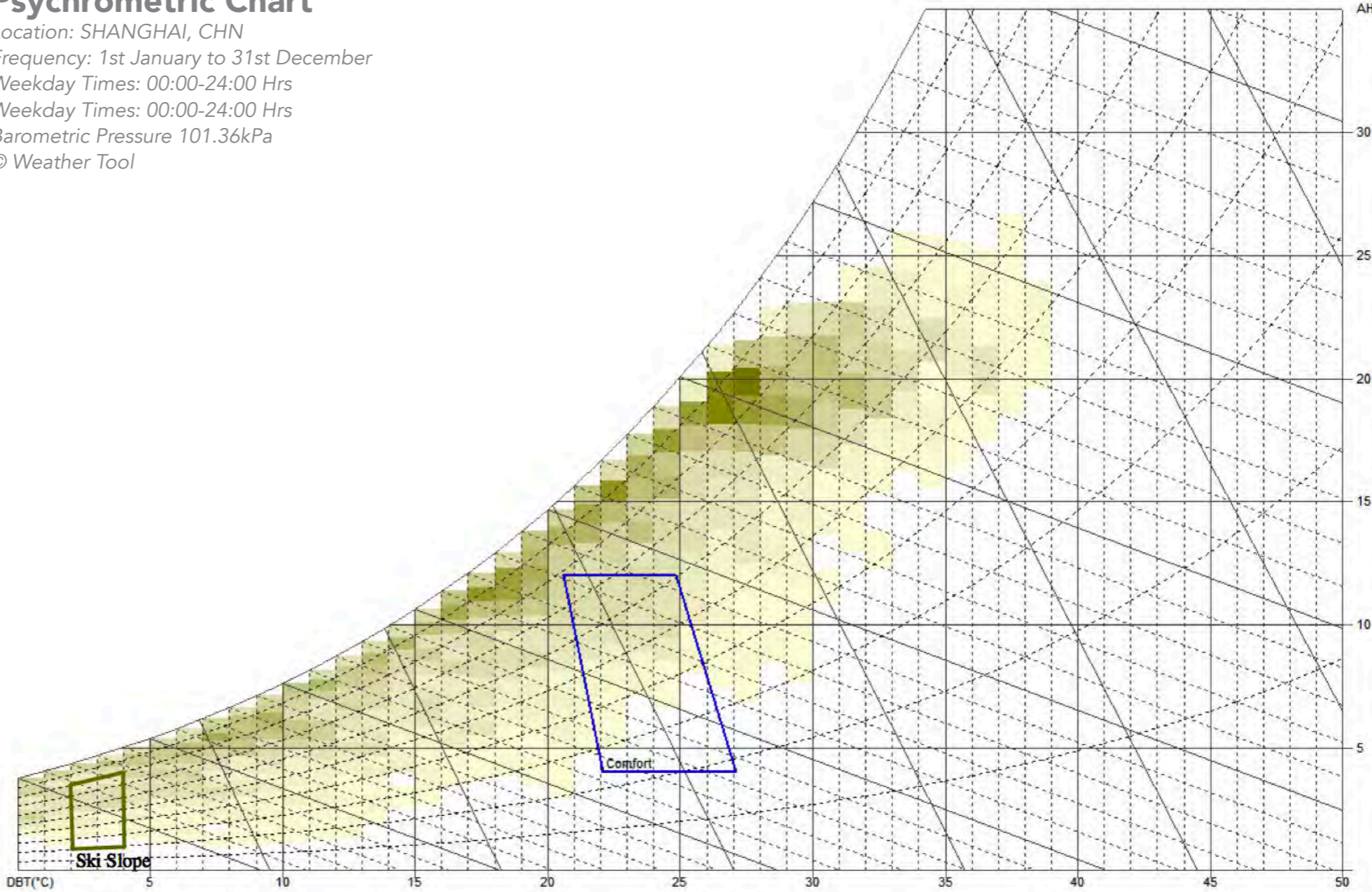

Snow-making

Unlimited Snow is the only one stop shop in the world to manage and build systems for next generation indoor snow parks. With US' advanced snow making technology the authentic snow amusement experience can be realized in virtually any location and climate. The team has previously taken part in the snow making process of many snow domes and outdoor events in Europe and all around the world. Whenever in need, US makes real snow to accomplish missions previously regarded as impossible.



VACUUM SNOW TECHNOLOGY

- Suitable for any temperature.
- Large capacity snow making.

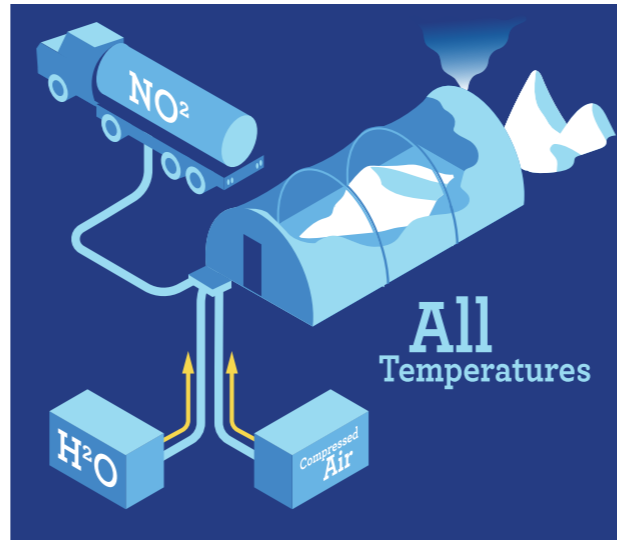

CRYOGENIC SNOW TECHNOLOGY

- Suitable for any temperature.
- Faster snow-making production.

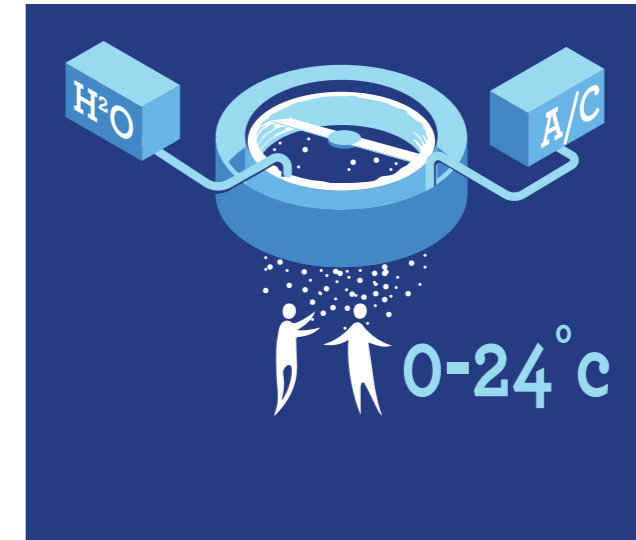

SNOW SHOWER TECHNOLOGY

- Suitable for any temperature.
- Real snow fall.

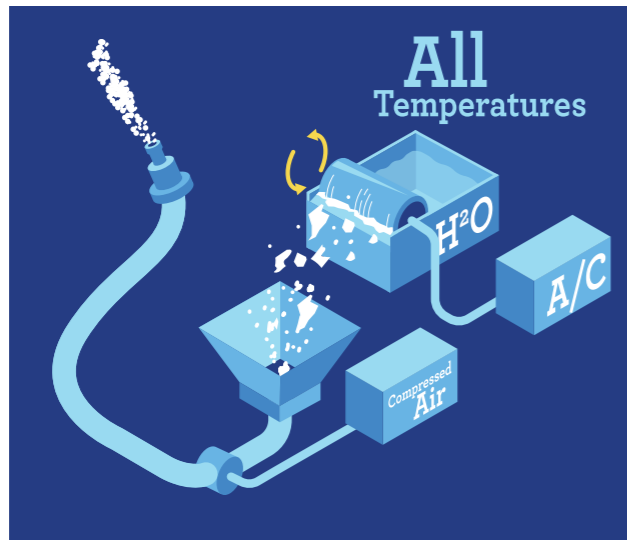

ICE FLAKE TECHNOLOGY

- Suitable for any temperature.
- Applicable for almost any event.

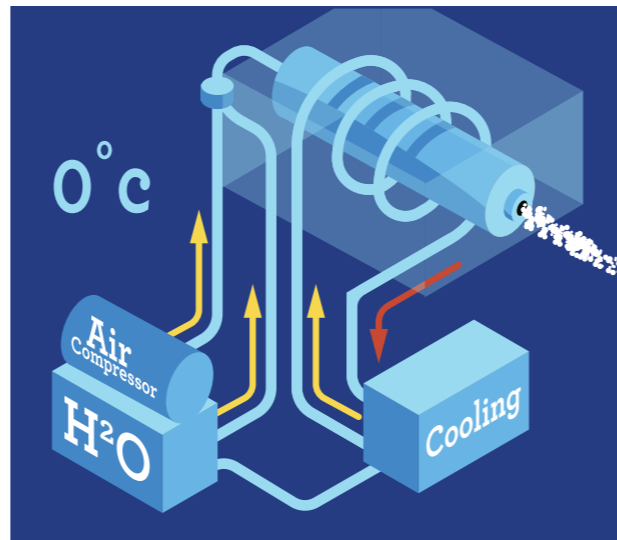

INNER-COOLED SPRAY TECHNOLOGY

- Suitable from zero to below freezing temperature.
- Especially for indoor ski slopes and snow play areas.



AIR-COOLED SPRAY TECHNOLOGY

- Below freezing temperature required.
- Applicable for indoor and outdoor events.

Construction

What defines a snow project's performance can depend on the smallest details. Reliability is a key concern, so US engineers and integrated design teams evaluate and consider all materials and components of a construction. US projects are required to operate at low running cost without affecting quality and durability. Unlimited Snow pursues excellence in high-performance building systems that are most suitable for managing snow and ice indoors.

US has gained thorough experience in insulation, indoor climate control, damp-proofing, and decision making in response to engineering challenges such as also making structures transportable and lightweight. This results in the creation of the most reliable structures, working in perfect harmony with snow, ice and visitors.

- RELIABILITY
- INTEGRATION
- DETAILS



Envelope

The design of the envelope of the snow park shall consider the following specific requirements:

- Thermal insulation
- Condensation risk assessment
- Air tightness
- Structural movements
- Water tightness and drainage

THERMAL INSULATION

The thermal performance of the enclosure must be excellent to prevent the transmission of the warm exterior into the ski enclosure. Detailed studies will be required to understand the internal conditions throughout the volume of the internal enclosure. As the design develops particular attention must be applied to the design of all interfaces and structural movement joints where local reduced performance may occur. Review of any penetrations (for example to support access and maintenance equipment) should be carried out to mitigate the risk of cold bridges through the facade.

CONDENSATION RISK

Vapor permeability of each element the roof envelope shall be designed and specified to avoid condensation occurring on cold surfaces or inside the weather barrier. This requires thermal modelling of the typical roof build up in different climate condition to verify that the position of the vapor barriers is effective throughout the year. Thermal bridges and penetrations also need careful detailing and modelling.

AIR TIGHTNESS

The air tightness of the enclosure will be critical to the success of the project from an energy standpoint. Air leakage is likely at a number of locations such as: between cladding sheets, at interfaces with the perimeter of the building, at interfaces with the adjacent structures and at any movement joints. Testing of certain arrangements should be considered as the design develops. Due to the large change in height of the covered ski tunnel internal air movements and the stack effect are likely to affect the actual leakage through the external skin. We would recommend that the project specification requires detailed testing of the contractor's proposed jointing arrangement to justify its air tightness performance.

STRUCTURAL MOVEMENTS

The thermal performance of the enclosure must be excellent to prevent the transmission of the warm exterior into the ski enclosure. Detailed studies will be required to understand the internal conditions throughout the volume of the internal enclosure. As the design develops particular attention must be applied to the design of all interfaces and structural movement joints where local reduced performance may occur. Review of any penetrations (for example to support access and maintenance equipment) should be carried out to mitigate the risk of cold bridges through the facade.

WATER TIGHTNESS AND DRAINAGE

The external cladding should be developed to provide a fully weather tight enclosure. In particular, the 3-dimensional analysis of the slope will inform the refinement of the shape and the positioning of gutters for the collection of rainwater.



Attraction

INNOVATIVE - CUSTOMIZED - DURABLE IN LOW TEMPERATURE

US is the leading developer to produce innovative and unique attractions in a snow and ice environment. US' attraction development team and related sub-consultants have researched and produced a wide range of attraction systems, never experienced before. These systems include: electrical indoor snowmobiles, snow diggers, laser gun ice bumper cars, adventure games over snow, special snowball games, simulators, reservation & ticketing systems and many more.

Unlimited Snow also collaborates with the new generation track & trace video system - TapeMyDay - automatically films, edits, and distributes a personalised guest video covering the entire visit in theme parks, introducing an opportunity for additional revenue.

Unlimited Snow has developed more than 50 different types of snow and ice attractions, below are some examples.



- WOW FACTOR
- GUEST FRIENDLY
- GUARANTEED SAFETY
- IMMERSIVE EXPERIENCE

The success of theme parks heavily depends on the post-construction phase and its later steps. Operational knowledge, also to be found in related industries, is crucial. Important projects benefit from advice and support of top operators and franchisees knowing about snow and ice.

Unlimited Snow has an entire team of specialized operators and managers who are experienced in running snow domes, ski resorts, indoor ski domes and theme parks. Together with the group of theme designers, engineers, trainers, and other staff members, US

prepares operational plans and training schemes most suitable for each specific turnkey project.

Once operational, Unlimited Snow persists on providing immersive experience with every detail of guest requirement and safety hazard considered. Guest experience and consumers' satisfaction remain key issues that should be monitored and taken care of with priority. It requires the best expertise to "bring Disneyland into the snow dome". US can do it.



Unlimited Snow

Nieuwe Gracht 11, 2011 NB Haarlem, Netherlands
+31 (0)20 4714640 / +31 (0)88 snowbiz
us@snow.biz
www.snow.biz



NO PART OF THIS DOCUMENT MAY BE REPRODUCED, COPIED OR TRANSFERRED TO OTHERS IN ANY FORM WITHOUT THE EXPLICIT WRITTEN AUTHORIZATION OF UNLIMITED SNOW. OBVIOUS OMISSIONS OR CLEAR MISTAKES CANNOT BE USED AGAINST UNLIMITED SNOW. IN CASE OF ANY CONFLICTS, DUTCH LAW AND JURISPRUDENCE WILL APPLY.