



# UNLIMITED SNOW

for all imaginable **snow & ice** leisure experiences

**SNOW & ICE AMUSEMENT PARKS**

**MIXED-USE DESTINATIONS**

**INDOOR WINTER SPORTS**

**YOUR ONE STOP SHOP FROM START...**



TWIN PEAKS (BY ALVINA/US)

TWIN PEAKS MIXED USE WITH TERRACED APARTMENTS (BY S333/US)

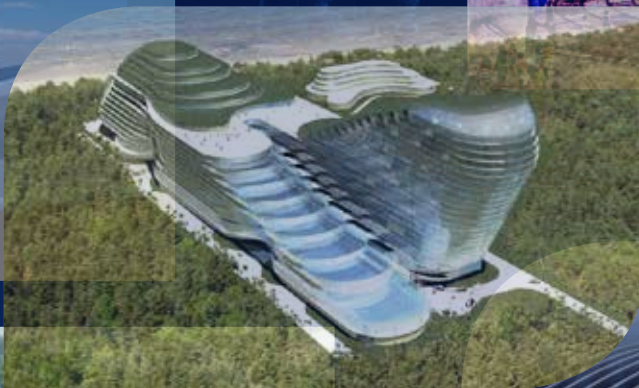

ALPS WINTERLAND MIXED USE (BY S333/US)

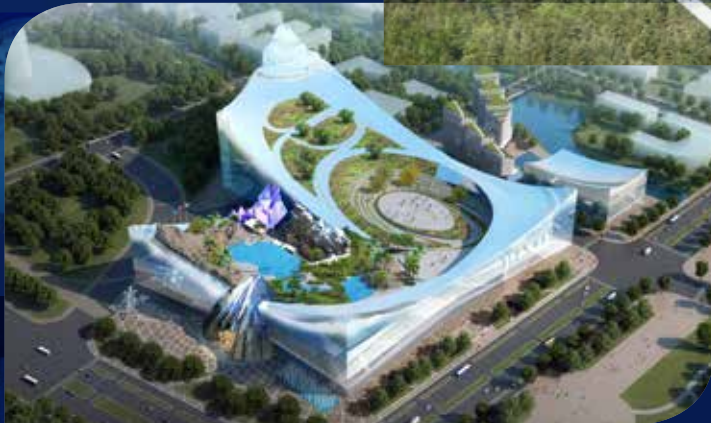

ALPS WINTERLAND MIXED USE (BY S333/US)

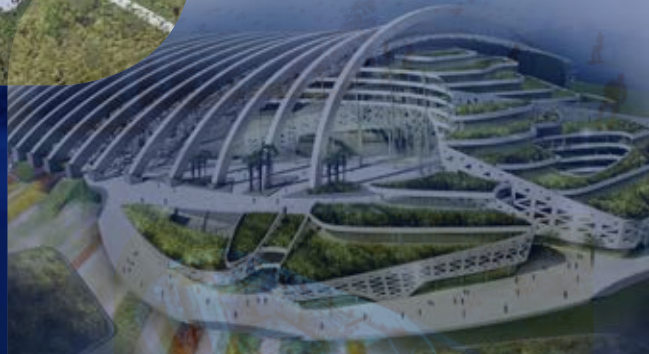

ARCTIC WORLD RESORT MIXED USE (BY MATTHIAS/US)

**...TO FINISH**

# About 'US'

Unlimited Snow provides best solutions for all imaginable snow & ice leisure experiences with its creations and is known for its innovative and original concepts. Its "snow-how" is based on the experiences gained from many existing projects, continuous research and development. Services range from the realisation of turnkey projects to customised specialised advice and individual products. Unlimited Snow has a highly specialised team with the

technological, commercial and design experience in providing these facilities throughout the process. This ensures that budgets are maintained and that the highest quality in terms of finish, environment, safety and the final experience are achieved. Investors and owners can relax in the knowledge that Unlimited Snow is working to achieve maximum returns using the best and most efficient solutions tailored to the location and target groups.

## INSTANT FUN OR SPORTIVE ATTRACTIONS FOR:

## SUMMARY SERVICES FROM START TO FINISH:

- Theme & water parks
- Family & urban entertainment centres
- Sports facilities & urban hills
- Shopping malls & casinos
- Summer & winter resorts
- Choice of various above and below freezing snow & ice making systems for snow & ice play, snow domes, skating rinks, animal environments in zoos, saunas, science centres, events and more.

- Concept development & architectural design
- Feasibility studies & business plans
- Project consulting & project management
- Engineering & technical installations
- Climate control & snowmaking-systems
- Ice rinks & ice climbing
- Rides & attractions
- Specialist equipment & systems
- Theming & special effects
- Prefab & instant structures
- Operational support & management
- Merchandising & promotion
- Additional leisure facilities and franchise

## SnowPlay

- "Snowplay" is an amazing snow & ice amusement park for kids of all ages with over 50 possible different attractions.

It can include various snow mountain slides, toboggan runs, kids snowmobiling, snowball arena, snowball challenge, rotating snow tubing disc, snow laser games, snow diggers, snow play, snow carousel, snow zorbing, snow volleyball, snow soccer, ice bowl, ice wave slide, snow golf, adventure mini golf on ice, bumper cars and alpine curling on ice, human curling, ice skating & hockey, ice bars, ice maze, real or synthetic ice climbing, ice carving, glacier walk, caving, ice sculptures exhibition, mining, Santa's grotto, high ropes course with thrill jump, bob run, straight or rollercoaster zipline, roll glider, ski jumping simulator, snowball carousel, (rein)deer rodeo, snowman wrestling, glass igloo bars, as well as winter themed storytelling, photo booth, soft play, adventure tower, dark ride, train ride, human pinball, ski cabin lift ride, and more.

Besides permanent facilities there are also possible relocatable or touring SnowPlay structures available.



SNOW PARK



SNOW VILLAGE

SNOW PARK



SNOW PARK REVIT MODEL EXAMPLE



IGLOO PARK



SNOW PLAY

IGLOO SNOW PLAY





ARCTIC WORLD RESORT

## Alps or Arctic World Resorts

The "Alps or Arctic World Resorts" are unique mixed-use destinations where visitors are "beamed" into fantastic Alpine or Arctic themed landscapes featuring snowy mountains, frozen rivers, frozen waterfalls, ice caves, chalets, huts, trees, snowfall, day and night projections of moving clouds, icebergs and Auroras, sound and scent effects and animatronic Alpine or Arctic animals. Other options are fairy tale theming using our own or third party IP. Any part or combination of the facilities featured in this brochure are possible. The start is creating a programme of requirements for any specific location to select the most appropriate activities and size in order to achieve maximum returns.



ALPS WORLD RESORT



ARCTIC WORLD RESORT

## Alpine or Arctic Village

- "Alpine or Arctic Village", real chalets and cottages with balconies and terraces e.g. accommodating a grand entrance, reception, lounge with fireplace, guest services, ski school, merchandising and sports shops, rental & dressing, themed restaurants, après ski bars, party rooms, winter related games and simulators, Alpine or Arctic edutainment and even themed hotel rooms overlooking the many attractions and impressive landscapes. Other facilities include machine room, storage, offices, etc.



ARCTIC WORLD RESORT



ALPS WORLD RESORT

ALPS WORLD RESORT



MUSCAT SNOW PARK FAÇADE

## SnowXS

- "SnowXS", a patented next generation snow dome representing a true indoor winter sports resort. A number of different ski lifts service the fully interconnecting natural blue, red and black slopes, as well as a possible slalom and moguls course, a big air jump, half-pipe and fun park. This provides a great perpetual experience for skiers and snowboarders from their first lessons to becoming elite competitors. It is taking the first generation of rectangular slopes to a next level. Underneath the slopes there is lots of space for a connecting parking, water park, shopping mall, amusement park, FEC, multiplex cinema, arcade, live entertainment, fitness, sports facilities, hotel, congress facilities, casino, apartments, offices, etc.



ARCTIC WORLD RESORT  
FEATURING SNOWXS

## Arctic Ocean

- "Arctic Ocean", an Arctic themed water park underneath the slope with various exciting slides, canyoning, water games, lazy river, an indoor beach with surfing as well as relaxing spa and wellness facilities including heat exchange with the snow environment.

## The Summit

- "The Summit", a (possibly rotating) restaurant at the top of the slopes offering magnificent views of the indoor resort and outdoor landscape.

## Igloo Village

- "Igloo Village", comprising of igloos made of real snow or ice with virtual camp fires, whirlpools and facilities for a most memorable overnight experience.



ARCTIC KART SNOW CIRCUIT

SNOW CIRCUIT WITH IGLOO VILLAGE

## Arctic Kart

- "Arctic Kart", featuring outrageous patented indoor snow circuits with bridges and tunnels for kids and adults snowmobiling, snow-kart, dog-sledding, cross-country skiing, laser biathlon and Nordic walking.



ALPS SHOP



ALPS CHECK-IN

## Snow Journey

- "Snow Journey" is a special franchised one way walkthrough experience, whereby visitors make a discovery tour to several Alpine countries. Each country is themed with specific national landmarks and sceneries and contains a number of fun snow & ice rides and attractions. Entrance and exit is through the merchandising shop. The reception is themed as airport check-in counters, where people purchase their flight tickets to the Alps. Subsequently they pass through a 4D theatre for a virtual flight to Innsbruck airport.



ALPS FLIGHT

After the touch down they enter the arrival hall, where they are provided with warm boots and clothing. After visiting Austria they cross the Brenner pass to Italy. The Mont Blanc tunnel leads to France and a lift cabin ride takes them to Switzerland. The journey ends in Germany. Each time they cross the border their virtual passport is stamped. With magic icicles visitors can go on a quest to search for clues, solve puzzles, trigger special effects, collect points and more throughout the whole facility as an additional Alps edutainment experience.



ALPS ARRIVAL HALL

## Technical Installations

- "Technical Installations", as an integral part of its snow & ice amusement parks Unlimited Snow provides a complete energy saving and radical CO2 reduction strategy. The prefab skid mounted machine room installations may include electricity and chilled water production by a CHP plant also combined with solar panels and e.g. climate control, snow & ice making as well as recycling of cold, heat, water. All fully automatic with long distance control etc. For every project the extremely durable high quality installations are tested and certified with the stamped, signed statement by TÜV before leaving the factory before being shipped for set-up and start-up onsite thereby saving considerable time.

AN EXAMPLE OF GIEBROS/US PREFAB TECHNICAL INSTALLATIONS



# Possible scope of services from start to finish:

The Outline Plan of Work organises the process of managing, and designing building projects and administering building contracts into a number of key Work Stages. The sequence or content of Work Stages may vary or they may overlap to suit the procurement method.

<p><b>A + B</b></p>	<p><b>Appraisal + Design Brief</b></p> <ul style="list-style-type: none"> <li>• Identification of client's needs and objectives, questionnaire</li> <li>• Identification of possible constraints on development</li> <li>• Preparation and assessment of feasibility studies and development options</li> <li>• Development of client requirements into Design Brief + programme of requirements</li> <li>• Identification of procurement method, organisational structure, range of consultants and phased offer • Preliminary feasibility calculation based on questionnaire including general description</li> </ul>	<ul style="list-style-type: none"> <li>• Detailed design &amp; theming: Defining safety, operational and maintenance conditions</li> <li>• Detailed scenery design - Detailed projection design - Detailed special effects design - Detailed audio design - Detailed lighting design - Detailed digital signing design - Show control brand selection - Detailed show control design.</li> <li>• Detailed scenery design Autocad drawings</li> <li>• Detailed design snow &amp; ice area including optional Revit model</li> <li>• IP Reviews</li> <li>• Revised cost plan / survey of quantities</li> <li>• C&amp;S work packages: detail design, key details, spatial coordination</li> <li>• MEP work packages: spatially coordinated schematic layouts with key details and invert positions</li> <li>• Environmental analysis / sustainability</li> <li>• Envelope</li> <li>• Accoustics</li> <li>• CDM (Construction Development Management act - health &amp; safety)</li> <li>• Fire Strategy</li> <li>• BREEAM</li> <li>• Final artist impressions and optional animations and optional model</li> <li>• Merchandising design</li> <li>• Project management</li> </ul>
<p><b>C</b></p>	<p><b>Concept Design</b></p> <ul style="list-style-type: none"> <li>• Site visit specialist consultants</li> <li>• Site / building survey (foundations, measurements, etc.)</li> <li>• As built AutoCAD drawings (in case of existing building)</li> <li>• Experience concept design (masterplan): story / Attraction selection / Concept positioning attractions / Guests' experience description.</li> <li>• IP License &amp; Franchise agreement</li> <li>• Preliminary architectural concept design + concept integration of services and layout plans drawn in AutoCAD</li> <li>• Preliminary 3D artist impressions and optional animations</li> <li>• C+S: Preliminary sketches of structural design &amp; physical requirements, insulation values, etc.</li> <li>• MEP: Preliminary sketches of building services systems and climate conditions</li> <li>• Environmental analysis / sustainability</li> <li>• Traffic analysis</li> <li>• Preliminary snow &amp; ice production calculations and power &amp; water supply requirements</li> <li>• Preliminary local cost plan</li> <li>• General feasibility including extensive parameters, preliminary operations forecast, investment estimate, IRR calculation</li> <li>• BREEAM (Environmental Assessment Method)</li> <li>• Project management</li> </ul>	<p><b>E</b></p> <p><b>Information Required for Tender Action</b></p> <ul style="list-style-type: none"> <li>• Architectural drawings, schedules, specification of materials and workmanship required for Tender purposes</li> <li>• MEP schedules, specifications</li> <li>• C+S schedules, specifications</li> <li>• Final cost plan / survey of quantities</li> <li>• Materials list</li> <li>• Final investment estimate incl. supplier details</li> <li>• Other consultants &amp; any required changes</li> <li>• Project management</li> </ul>
<p><b>D</b></p>	<p><b>Design Development / Schematic Design</b></p> <ul style="list-style-type: none"> <li>• Development of concept design to include structural and building services systems + planning application submission if appropriate</li> <li>• Design development of technical installations for costing purposes and budget</li> <li>• Preliminary design &amp; theming: Defining space and budget</li> <li>• Preliminary attraction layout</li> <li>• Preliminary scenery design</li> <li>• Preliminary projection design</li> <li>• Preliminary lighting design</li> <li>• Preliminary audio design</li> <li>• Preliminary special effects design</li> <li>• Preliminary digital signage design</li> <li>• Preliminary show control design</li> <li>• Architectural design development</li> <li>• IP Reviews</li> <li>• Sourcing of attractions and equipment</li> <li>• Revised cost plan / survey of quantities</li> <li>• C&amp;S report &amp; sketches to include loads, variations, options for costing &amp; production final scheme</li> <li>• MEP report &amp; sketches to include basic system descriptions &amp; specifications: mechanical, ventilation, air distribution, electrical</li> <li>• Environmental analysis / sustainability</li> <li>• Accoustics</li> <li>• CDM (Construction Development Management act - health &amp; safety)</li> <li>• Fire Strategy</li> <li>• Logo and character design</li> <li>• Project management</li> </ul>	<p><b>F</b></p> <p><b>Tender Action</b></p> <ul style="list-style-type: none"> <li>• Preparation of Tender documentation</li> <li>• Identification of potential contactors or specialist subcontractors</li> <li>• Appraising tenders / making recommendations to the client</li> </ul> <p><b>G + H</b></p> <p><b>Implementation</b></p> <ul style="list-style-type: none"> <li>• Building implementation to practical completion. Administration of building contract; issuing of information to the contractor; reviewing information provided by contractor and specialists</li> <li>• Interior and rides / attractions implementation to practical completion</li> <li>• Contract and cost control</li> <li>• Shopdrawings, production drawings</li> <li>• Machine room installations</li> <li>• Theming &amp; furnishing incl. light, AV, effects</li> <li>• Rides &amp; attractions</li> <li>• General systems and equipment</li> <li>• Merchandising and rental &amp; personnel clothing</li> <li>• Handling suppliers</li> <li>• Supplier supervisors for on site installation</li> <li>• Show control, testing &amp; programming</li> <li>• Descriptions &amp; procedures start-up machine room</li> <li>• Certifications</li> <li>• Project management incl. on site</li> </ul>
<p><b>E</b></p>	<p><b>Technical Design / Detailed Design</b></p> <ul style="list-style-type: none"> <li>• Building: Detailed architectural drawings, material and finishes list + Building Regulations submission, if appropriate</li> <li>• Rides: Detail design + material and finishes list</li> <li>• Facilities: Reception, rental, F&amp;B and circulation areas interior design, detail design + material and finishes list</li> <li>• Engineering of technical installations, working drawings, details, materials, machine room layout, final budget</li> </ul>	<p><b>J + K</b></p> <p><b>Post Practical Completion</b></p> <ul style="list-style-type: none"> <li>• Administrating contract after Practical Completion and making final inspections</li> <li>• Assisting operator during initial occupation period</li> <li>• Review of project performance during use</li> <li>• BREEAM - EPC (Energy Performance Certificate)</li> <li>• Maintenance &amp; operational manuals (free of charge if part of franchise)</li> <li>• Expat staff sourcing fees as percentage of salaries</li> <li>• Training technical installations</li> <li>• Training operations</li> <li>• Possible management agreement</li> <li>• Possible ongoing franchise</li> </ul> <p><b>L</b></p>



**UNLIMITED SNOW**  
Nieuwe Gracht 11,  
2011NB Haarlem  
The Netherlands

Tel. +31 (0)20 4714640  
or +31 (0)88 snowbiz  
us@snow.biz  
www.snow.biz

